



Russo Barr Associates, Inc.

55 Sixth Road, Suite 6
Woburn, MA 01801

781-273-1537 tel
781-273-1695 fax

ADDENDUM NO. 1

TO: Prospective Bidders

PROJECT: **Flooring Replacement Project**
Witchcraft Heights Elementary School
Salem, Massachusetts
RBA Project No. 2021037
Salem Bid No. 22-11-250

FROM: Russo Barr Associates, Inc.
55 Sixth Road, Suite 6
Woburn, MA 01801
(781) 273-1537

DATE: January 31, 2022

This addendum modifies the Project Manual as noted below. Acknowledge receipt of this addendum in the space provided on the bid form. Failure to do so may subject the Bidder to disqualification.

The Bid Due Date has been changed. Bids are due on February 4, 2022, at 11:00 AM

This addendum consists of 6 pages (these 2 pages and 4 drawings).

QUESTIONS/CLARIFICATION

1. Is the Ceramic floor and wall tile in the toilet rooms included within the Bid? If so, we will need specifications.

Response: Ceramic Tile is not a part of this project. This project is only VCT flooring and cove base.

2. Is the rubber stair treads and risers included within the Bid? If so, we will need specifications.

Response: Rubber stair treads and risers are not a part of this project. This project is only VCT flooring and cove base.

3. Which specific Armstrong VCT "Premium Excelon" series product is required as there are various "Premium Excelon" products available at various costs?

*Response: The basis of design shall be **Armstrong VCT "Premium Excelon Crown Texture"**.*

4. Who will be responsible for the moving of the furniture, equipment and the electronics?

Response: All furniture, equipment, and items not permanently secured, will be removed by the School Department personnel.

CHANGE TO SPECIFICATIONS

1. Section 09 65 00 – Vinyl Composite Tile - Add the following:

Para. 2.01A.3. Floor tile for areas designated to be "NS-VCT" shall be Armstrong World Industries "Safety Zone" Series, 12"x12" tile, or similar slip resistant tile from the alternative acceptable product manufacturers.

CHANGES TO DRAWINGS

1. Add Drawings SK-1, SK-2, SK-3 and SK-4 for NS-VCT locations.

END OF ADDENDUM NO. 1

NS-VCT - Non-skid VCT to be installed where indicated

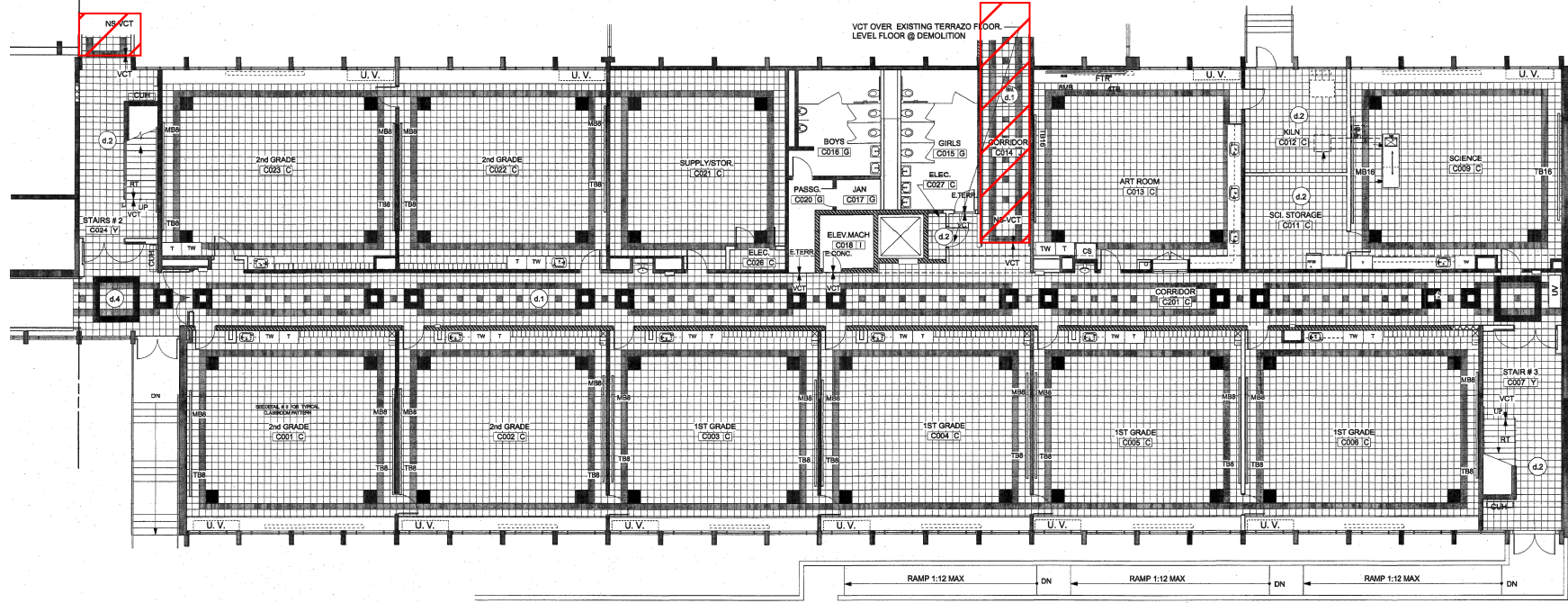

NOTE:
 1. DRAWINGS INDICATE THE LAYOUT OF EXISTING VCT TILE. CONTRACTOR SHALL REMOVE AND REPLACE ALL EXISTING VCT TILE AND VINYL BASE, AND REPLACE WITH NEW VCT TILE AND BASE TO MATCH EXISTING, INCLUDING LAYOUT AND COLOR SCHEME. OWNER TO APPROVE FINAL SELECTION OF ALL COLORS.

1 GROUND FLOOR PLAN - SEGMENT C
 SCALE 1/8" = 1'-0"

KEY PLAN

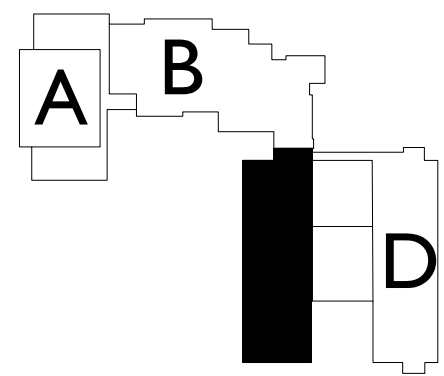

DESCRIPTION	
DATE	
NO.	
FLOOR REPLACEMENT PROJECT WITCHCRAFT HEIGHTS ELEMENTARY SCHOOL 1 FREDERICK STREET SALEM, MASSACHUSETTS GROUND FLOOR PLAN - SEGMENT C NS-VCT LOCATIONS	
DATE	01.19.22
SCALE	AS NOTED
DRAWN BY / CHECKED BY	DJS / ANB
PROJECT NO.	2021037
DRAWING NO.	
SK-2	

NS-VCT - Non-skid VCT to be installed where indicated, these areas not previously indicated

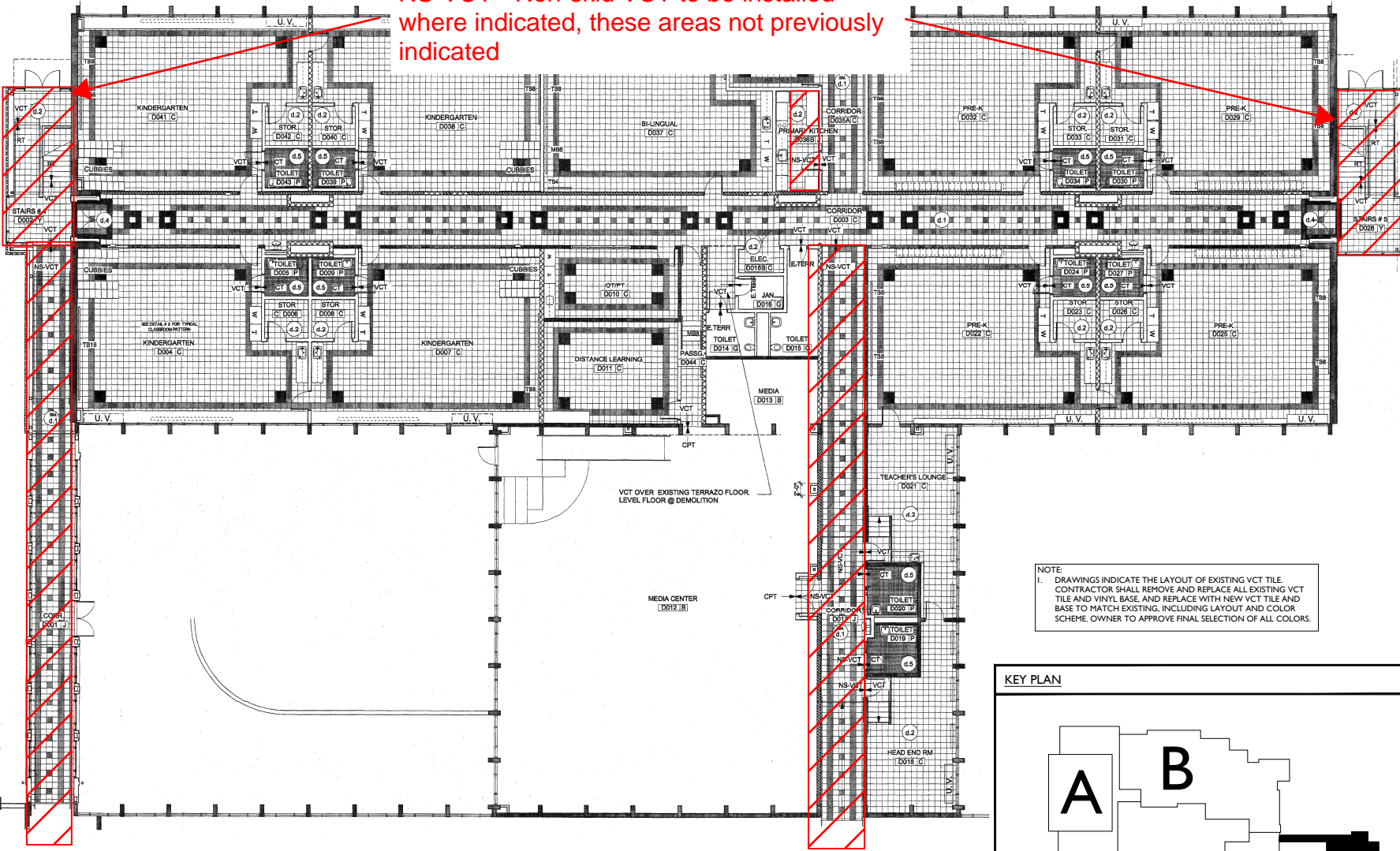

1 GROUND FLOOR PLAN - SEGMENT D
SCALE: 1/8" = 1'-0"

NS-VCT - Non-skid VCT to be installed where indicated

KEY PLAN

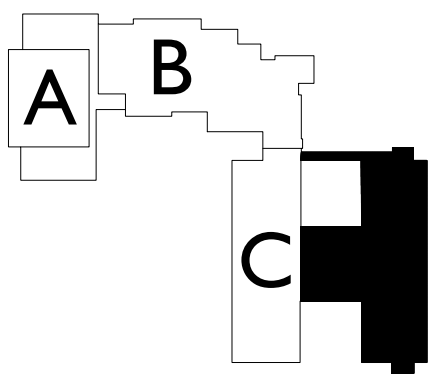

DESCRIPTION	
DATE	
NO	
FLOOR REPLACEMENT PROJECT WITCHCRAFT HEIGHTS ELEMENTARY SCHOOL 1 FREDERICK STREET SALEM, MASSACHUSETTS	
DATE	01.19.22
SCALE	AS NOTED
DRAWN BY / CHECKED BY	DSJ / ANB
PROJECT NO.	2021037
DRAWING NO.	
GROUND FLOOR PLAN - SEGMENT D NS-VCT LOCATIONS	
SK-3	

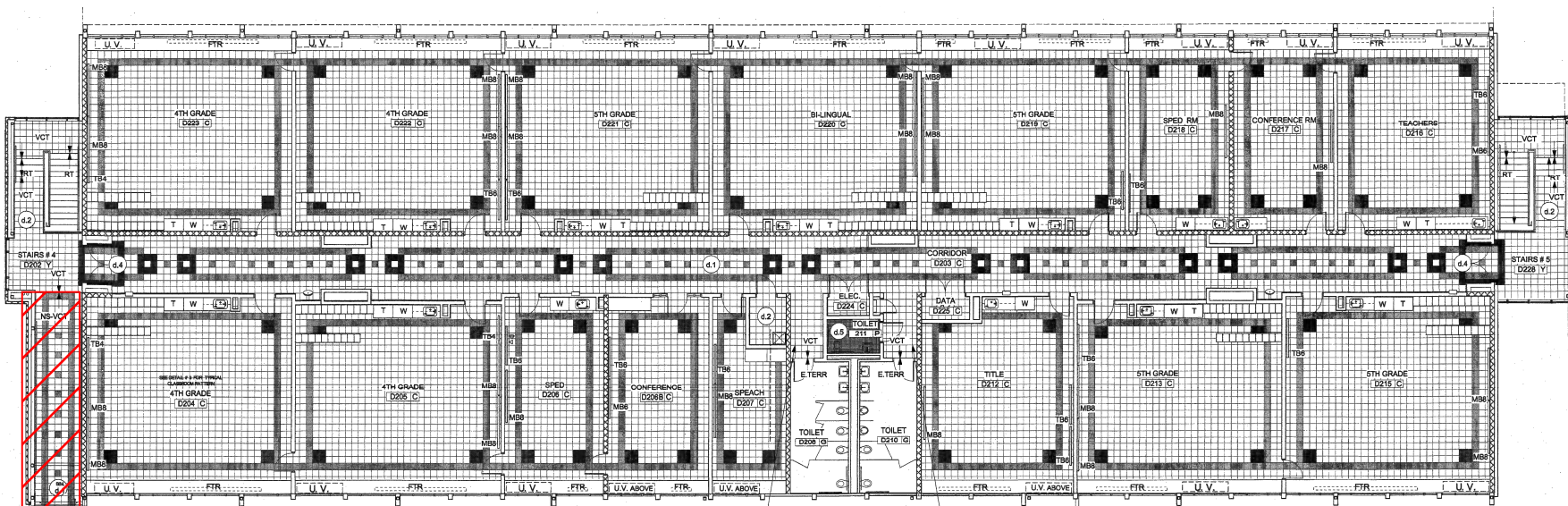

VCT OVER EXISTING TERRAZO FLOOR.
LEVEL FLOOR @ DEMOLITION

NS-VCT - Non-skid VCT to be installed where indicated

NOTE:
1. DRAWINGS INDICATE THE LAYOUT OF EXISTING VCT TILE. CONTRACTOR SHALL REMOVE AND REPLACE ALL EXISTING VCT TILE AND VINYL BASE, AND REPLACE WITH NEW VCT TILE AND BASE TO MATCH EXISTING, INCLUDING LAYOUT AND COLOR SCHEME. OWNER TO APPROVE FINAL SELECTION OF ALL COLORS.

① SECOND FLOOR PLAN - SEGMENT D
SCALE: 1/8" = 1'-0"

KEY PLAN

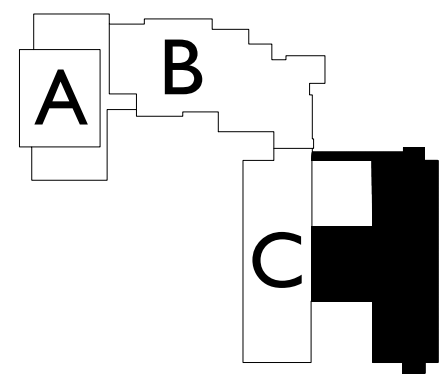

DESCRIPTION	
DATE	
NO.	
FLOOR REPLACEMENT PROJECT WITCHCRAFT HEIGHTS ELEMENTARY SCHOOL 1 FREDERICK STREET SALEM, MASSACHUSETTS SECOND FLOOR PLAN - SEGMENT D - NS-VCT LOCATIONS	
DATE	01.19.22
SCALE	AS NOTED
DRAWN BY / CHECKED BY	DJS / ANB
PROJECT NO.	2021037
DRAWING NO.	SK-4