

- NOTES:**
1. CONTRACTOR TO SURVEY AND CONFIRM STRUCTURE RIM ELEVATIONS AND DEPTHS.
 2. LOCATION AND ELEVATION OF EXISTING SEWER SERVICES TO BE DETERMINED IN FIELD THROUGH BASEMENT SURVEYS AND/OR EXCAVATION. CAMERA, LAUNCH, AND LOCATE SIDEWALK CONNECTION LOCATION/DEPTH

Client	CITY OF SALEM, MASSACHUSETTS
Project	GARDNER STREET AND CABOT STREET SEWER REPLACEMENT
	GARDNER

Scale	1"=20'
Date	5/8/2023
Job	Salem-Broadway
Designed by	WMR
Drawn by	BAT
No.	
Description	
Date	
File:	W:\Salem\Salem On Call Services\IFB 23-20-DPS On Call Equip-Laborers\Task Order - Gardner St Sewer\CAD\Gardner St Sewer

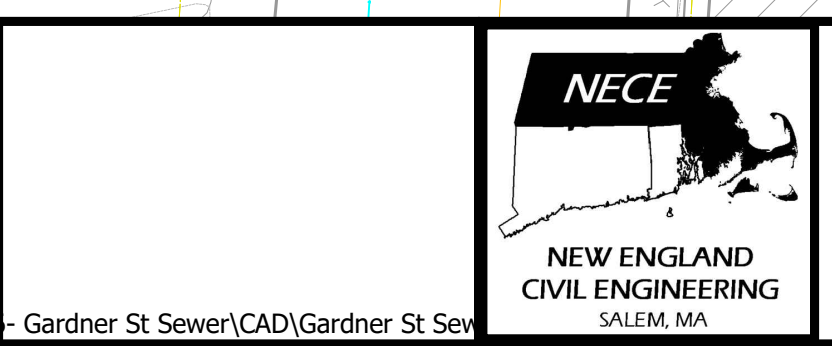

New England Civil Engineering Corp.
 265 Essex Street, Suite 102
 SALEM, MASSACHUSETTS

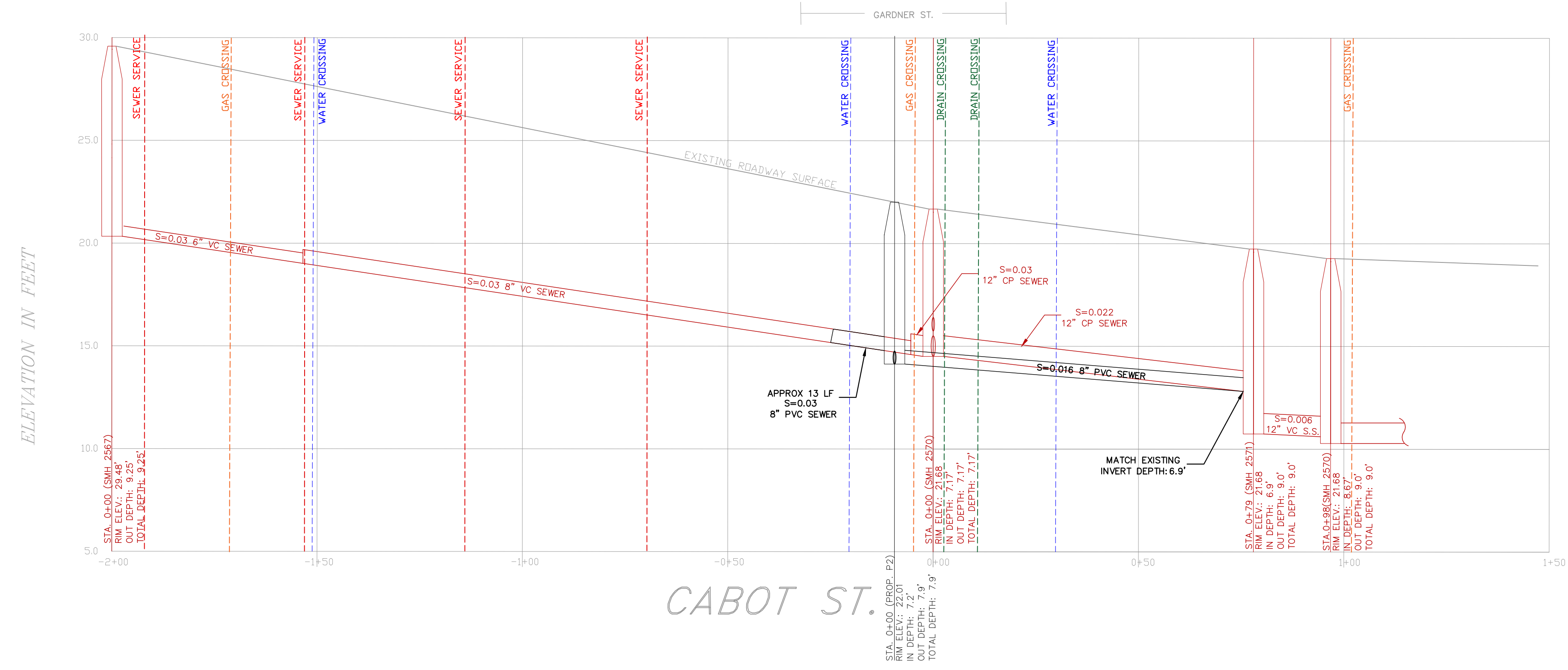
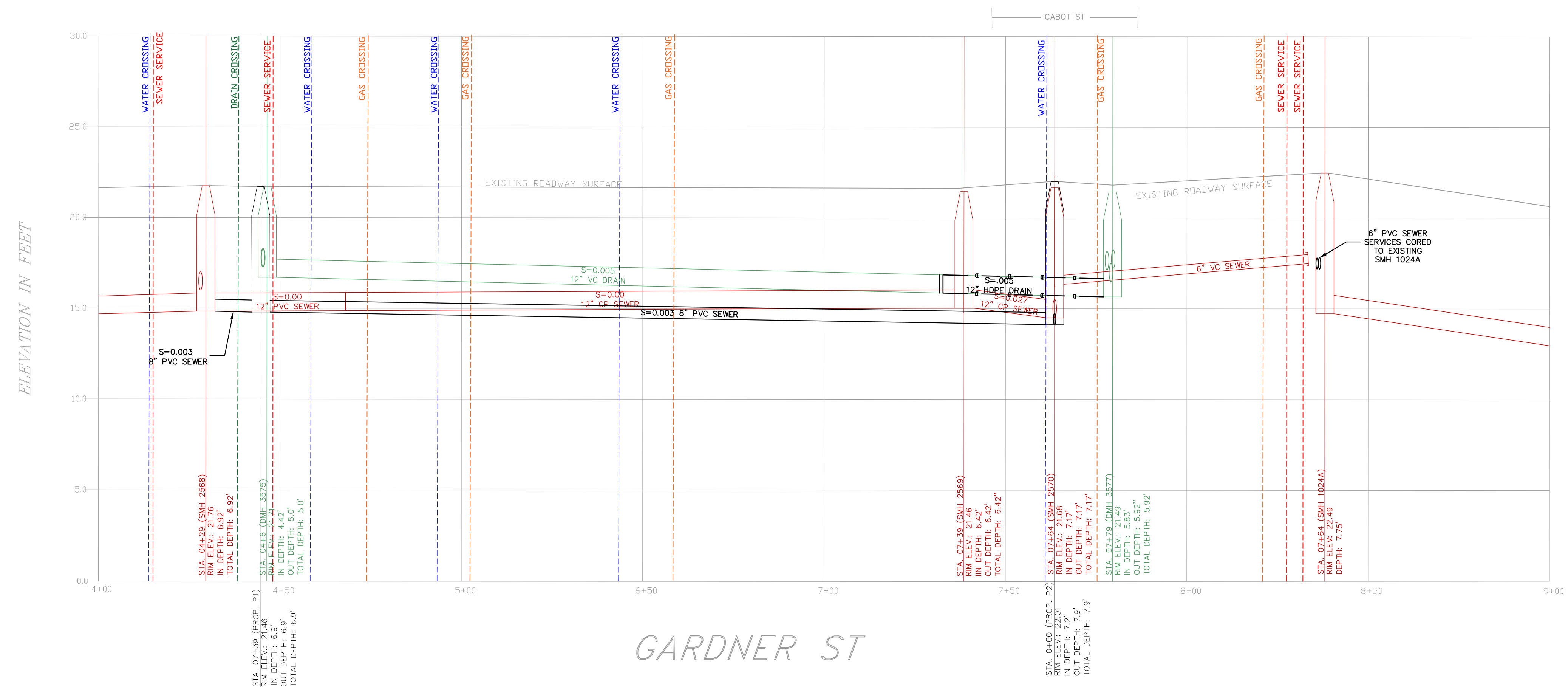

- NOTES:
1. REFER TO PAGES C-1 FOR PLAN VIEW OF PROPOSED SEWER WORK ON GARDNER ST.
 2. CONTRACTOR TO SURVEY AND CONFIRM STRUCTURE RIM ELEVATIONS AND DEPTHS.
 3. LOCATION AND ELEVATION OF EXISTING SEWER SERVICES TO BE DETERMINED IN FIELD THROUGH BASEMENT SURVEYS AND/OR EXCAVATION, CAMERA, LAUNCH, AND LOCATE SIDEWALK CONNECTION LOCATION/DEPTH

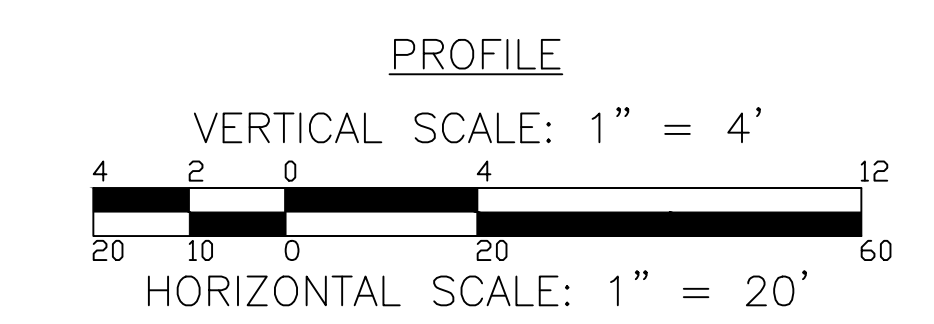

Client	CITY OF SALEM, MASSACHUSETTS
Project	GARDNER STREET AND CABOT STREET SEWER REPLACEMENT
	GARDNER

Scale	1"=20'
Date	5/8/2023
Job	Salem-GARDNER ST
Designed by	WMR
Drawn by	BAT/KBS
No.	
Description	
Date	
File:	W:\Salem\Salem On Call Services\IFB 23-20-DPS On Call Equip-Laborers\Task Order - Gardner St Sewer\CAD\Gardner St Sewer

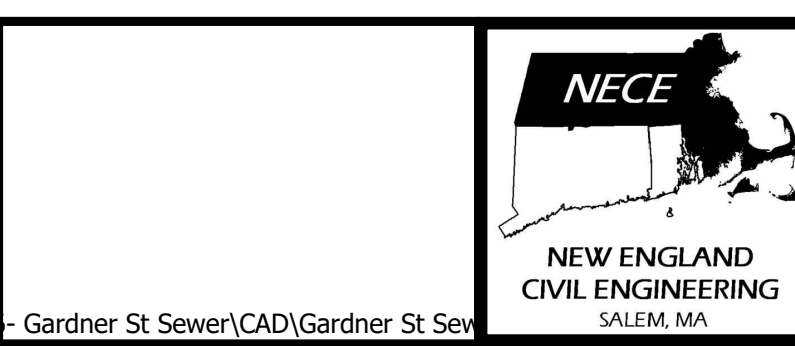

New England Civil Engineering Corp.

265 Essex Street, Suite 102
SALEM, MASSACHUSETTS

Sheet

P-1